

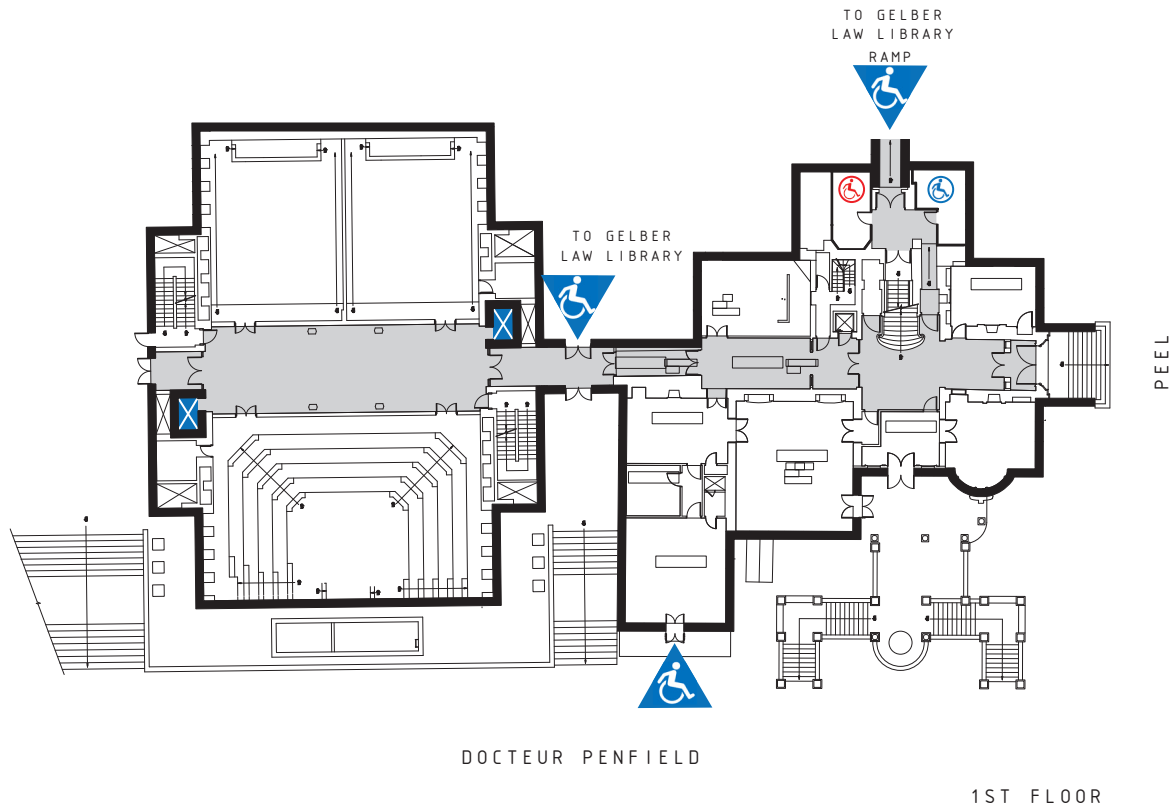

CHANCELLOR DAY HALL (OLD & NEW) 3644 PEEL



ENTRANCE

ACCESS VIA THE GELBER LAW LIBRARY

ELEVATOR

NEW CHANCELLOR DAY HALL: ALL LEVELS ARE ACCESSIBLE BY PUBLIC ELEVATORS. OLD CHANCELLOR DAY HALL: 1ST BASEMENT, 1ST, 2ND AND 3RD FLOORS ARE ACCESSIBLE BY PUBLIC ELEVATORS

WASHROOMS

NEW CHANCELLOR DAY HALL: ACCESSIBLE WASHROOMS ON 3RD, 5TH AND 6TH FLOORS

BUILDING CONNECTION

ACCESS FROM NEW TO OLD WING ON 1ST BASEMENT AND 1ST FLOOR. 1ST FLOOR CONNECTS WITH GELBER LAW LIBRARY



ACCESSIBLE ENTRANCE



ELEVATOR



MEN'S WASHROOM



WOMEN'S WASHROOM



UNISEX WASHROOM